

**209972**  
**VO M2.6-90**  
**Attachment optics**

- To deflect the beam, it is mounted on the transmitter probe.

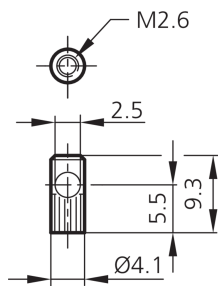

<b>Technical data (typ.)</b>	<b>+20°C</b>
Thread	M2.6
Light aperture	radial
Component	Attachment optics
To be used for	Plastic fiber optics
Ambient temperature during operation	-40 ... +70 °C
<b>More information / accessories</b>	<b><a href="https://www.di-soric.com/209972">https://www.di-soric.com/209972</a></b>