

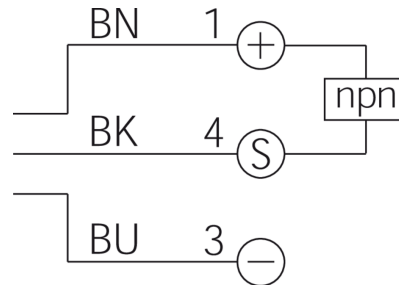

209332
DCB 12 MB 04 NS-3
Inductive proximity sensor

- Integrated amplifier
- Short-circuit protection
- Starting pulse suppression
- 4 LEDs for switching status display

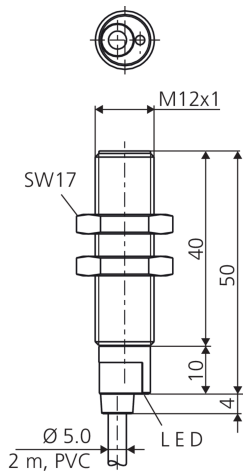

BK: black BN: brown BU: blue

Function

--	--	--	--	--	--	--	--	--	--	--

Technical data (typ.)	+20°C, 24 V DC
Service voltage	10 ... 30 V DC
Internal power consumption	< 10 mA
Insulation voltage endurance	500 V
Installation type	Flush
Thread	M12 x 1
Housing length	49.8 mm
Housing material	Brass (nickel-plated)
Material of cable	PVC
Material	PBT (Sensor probe)
Protection class	III, operation on protective low voltage
Operating principle	inductive
Evaluation	digital
Design	Thread
Characteristics	increased operating distance
Product series	INE Extended
Switching output	npn, 200 mA, NO
Voltage drop (max.)	1.8 V (200 mA)
Switching distance (SN)	4 mm
Standardized measuring plate	12 x 12 x 1 mm
Switching hysteresis (max.)	1 ... 20 %

**209332****DCB 12 MB 04 NS-3****Inductive proximity sensor****Technical data (typ.)****+20°C, 24 V DC**

LED Anzeige

Yes

Switching frequency

2000 Hz

Ambient temperature during operation

-25 ... +70 °C

Protection type

IP 67

Connection

Cable, 2.0 m (flying leads)

More information / accessories<https://www.di-soric.com/209332>