



202983

OLS 12 V 2000-IBSL

Laser through-beam sensor, transmitter

- Compact design
- Collimated red-light laser
- Visible laser spot
- Robust metal housing

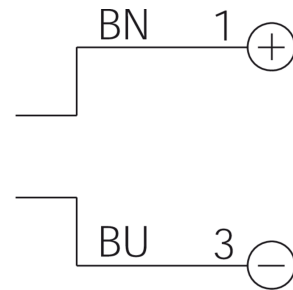
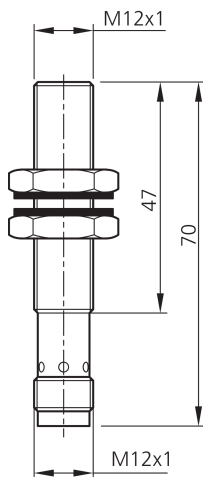
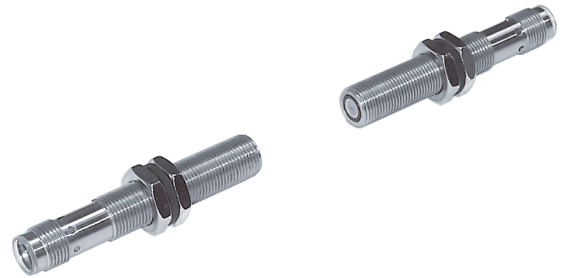

1) LED 4 x 90° (yellow)

BN: brown

BU: blue

Function



Technical data (typ.)

+20°C, 24 V DC

Service voltage	10 ... 35 V DC
No-load current (max.)	30 mA
Insulation voltage endurance	500 V
Thread	M12 x 1
Housing material	Stainless steel
Protection class	III, operation on protective low voltage
Operating principle	Through-beam sensor
Evaluation	digital
Design	Thread
Consisting of	Transmitter
Light source	Laser
Laser class	CLASS 1 LASER PRODUCT, 1 (IEC 60825-1:2014 / EN 60825-1:2014)
Color	Red
Wavelength	650 nm (Pp < 1.6 mW t = 6.5 µs)
Modulation	Clocked
Laser beam divergence	2 mrad
Range	0 ... 2000 mm
Sensitivity adjustment	no setting elements
Switching frequency	2000 Hz
Ambient temperature during operation	0 ... +50 °C



202983

OLS 12 V 2000-IBSL

Laser through-beam sensor, transmitter

Technical data (typ.)

+20°C, 24 V DC

Protection type

IP 67

Connection

Connector, M12, 4-pin

Connection cable

VK ...

More information / accessories

<https://www.di-soric.com/202983>